

This right of way map when recorded is an instrument of conveyance, transferring in accordance with Florida Statutes 337.29 and 335.0415 all right, title, and interest of Martin County in the road, street, highway, set forth on this map to the State of Florida Department of Transportation.

Recorded in Public Records of Martin County, Florida, this 21 day of December, A.D. 2010, in Road Plat Book 15, Page 3.

*[Signature]*  
Clerk of the Circuit Court  
Martin County, Florida

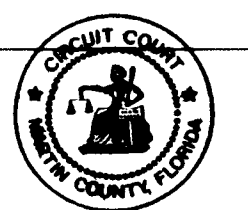

STATE OF FLORIDA  
DEPARTMENT OF TRANSPORTATION

MAPS OF THE  
STATE HIGHWAY  
MAINTENANCE MAP

STATE ROAD 714 (MONTEREY ROAD)  
ITEM/SEGMENT No. 2288621  
SECTION 89092-MAINT.(1)  
W.P.I. No. N/A  
MARTIN COUNTY  
LENGTH: 1.32 MI.

- REFERENCES:
- FDOT R/W MAP SEC. 89060-2503
  - FDOT R/W MAP SEC. 89512-2503
  - FDOT R/W MAP SEC. 89090-2515
  - FDOT R/W MAP SEC. 89090-2505
  - FDOT R/W MAP SEC. 89512-2601
  - FDOT R/W MAP SEC. 89060-5110
  - FDOT R/W MAP SEC. 89513-2601
  - FDOT R/W MAP SEC. 89010-2552

FIELD BOOK NUMBERS  
4318574, 4318575, 4318576

LEGEND

APPROX.	APPROXIMATE	NAD	NORTH AMERICAN DATUM
BLVD.	BASELINE OF SURVEY	N/A	NOT APPLICABLE
(C)	BOULEVARD	NL	NAIL
C.B.	CALCULATED DATA	NO.	NUMBER
€	CHORD BEARING	N.T.S.	NOT TO SCALE
CO.	CENTERLINE	N/TT	NAIL & TIN TAB
C.M.	COUNTY	N/W	NAIL & WASHER
CONC.	CONCRETE MONUMENT	ORB.	OFFICIAL RECORD BOOK
COR.	CONCRETE	(P)	PLAT DATA
D	CORNER	P.B.	PLAT BOOK
(D)	DEGREE	P.C.	POINT OF CURVE
DB.	DEED DATA	PG.	PAGE
Δ	DEED BOOK	P.I.	POINT OF INTERSECTION
DK	DELTA ANGLE	P.K.	PARKER KALON
(E)	DISK	PLS	PROFESSIONAL LAND SURVEYOR
EFB	EASTING	P.O.T.	POINT ON TANGENT
ESM'T.	ELECTRONIC FIELD BOOK	PROJ.	PROJECT
EXIST.	EASEMENT	PSM	PROFESSIONAL SURVEYOR AND MAPPER
FD.	EXISTING	P.T.	POINT OF TANGENT
F.D.O.T.	FOUND	R	RADIUS
F.E.C.	FLORIDA DEPARTMENT OF TRANSPORTATION	RGE.	RANGE
FED.	FLORIDA EAST COAST	R.L.S.	REGISTERED LAND SURVEYOR
FPL	FEDERAL	R.R.	RAILROAD
HWY.	FLORIDA POWER & LIGHT	R.R. SPK	RAILROAD SPIKE
GOV'T.	HIGHWAY	RT.	RIGHT
IP	GOVERNMENT	R/W	RIGHT-OF-WAY
IR	IRON PIPE	S.B.CO.	BELL SOUTH
IRC	IRON ROD	SEC.	SECTION
L	IRON ROD & CAP	S.R.	STATE ROAD
LB	LENGTH OF CURVE	STA.	STATION
LT.	LEFT	T	TANGENT
MAINT.	LICENSED BUSINESS	TWP.	TOWNSHIP
(N)	MAINTAINED	U.E.	UTILITY EASEMENT
	NORTHING	W/P.I.	WORK PROGRAM ITEM
		U.E.	UTILITY EASEMENT

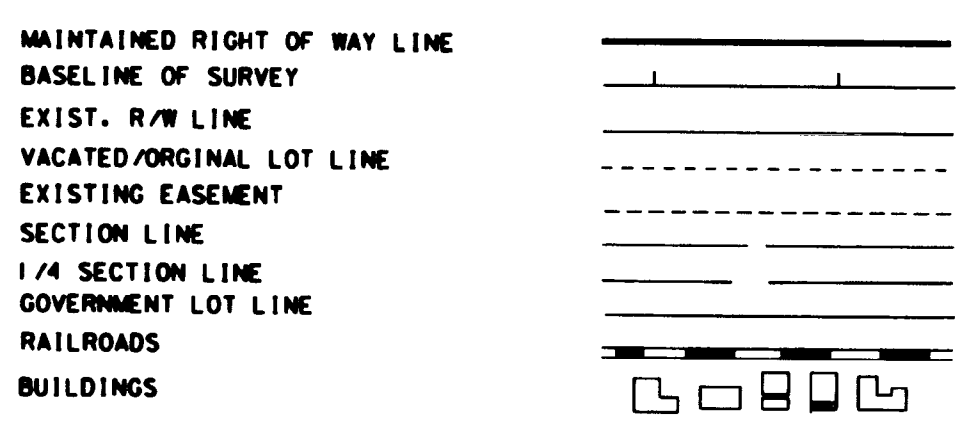

GENERAL NOTES

- BEARINGS AND COORDINATES ARE RELATIVE TO THE STATE PLANE COORDINATES, FLORIDA EAST ZONE, NORTH AMERICAN DATUM (NAD) OF 1983 (90 ADJUSTMENT). A BEARING OF S 40°41'46" W BEING ESTABLISHED BETWEEN FDOT MONUMENTS A20 STAMPED 714 89 98 GPS07 TO A33 STAMPED 714 89 98 GPS03
- GRID DISTANCES HAVE A SCALE FACTOR OF 1.00001.
- STATIONS AND OFFSETS ARE RELATIVE TO THE BASELINE OF SURVEY UNLESS OTHERWISE NOTED.
- BASELINE STATIONING IS AT 100 FOOT INTERVALS.
- ALL CONTROL POINTS IN PAVEMENT ARE PK. NAILS UNLESS OTHERWISE SPECIFIED.
- ALL CONTROL POINTS IN DIRT ARE 3/4" IRON RODS AND CAPS, OR 60D NAILS UNLESS OTHERWISE SPECIFIED.
- ALL DISTANCES, ANGLES, BEARINGS, STATIONS AND OFFSETS ARE CALCULATED UNLESS OTHERWISE NOTED.
- "PROJECT NETWORK CONTROL (P.N.C.) SHEETS HAVE BEEN PREPARED FOR THIS PROJECT. CERTIFIED COPIES ARE FILED WITH AND MAINTAINED BY THE DISTRICT FOUR SURVEY DEPARTMENT IN FORT LAUDERDALE, FLORIDA.

END MAINT. PROJECT No. 89092-MAINT.(1)  
@ STA. 147+10.01

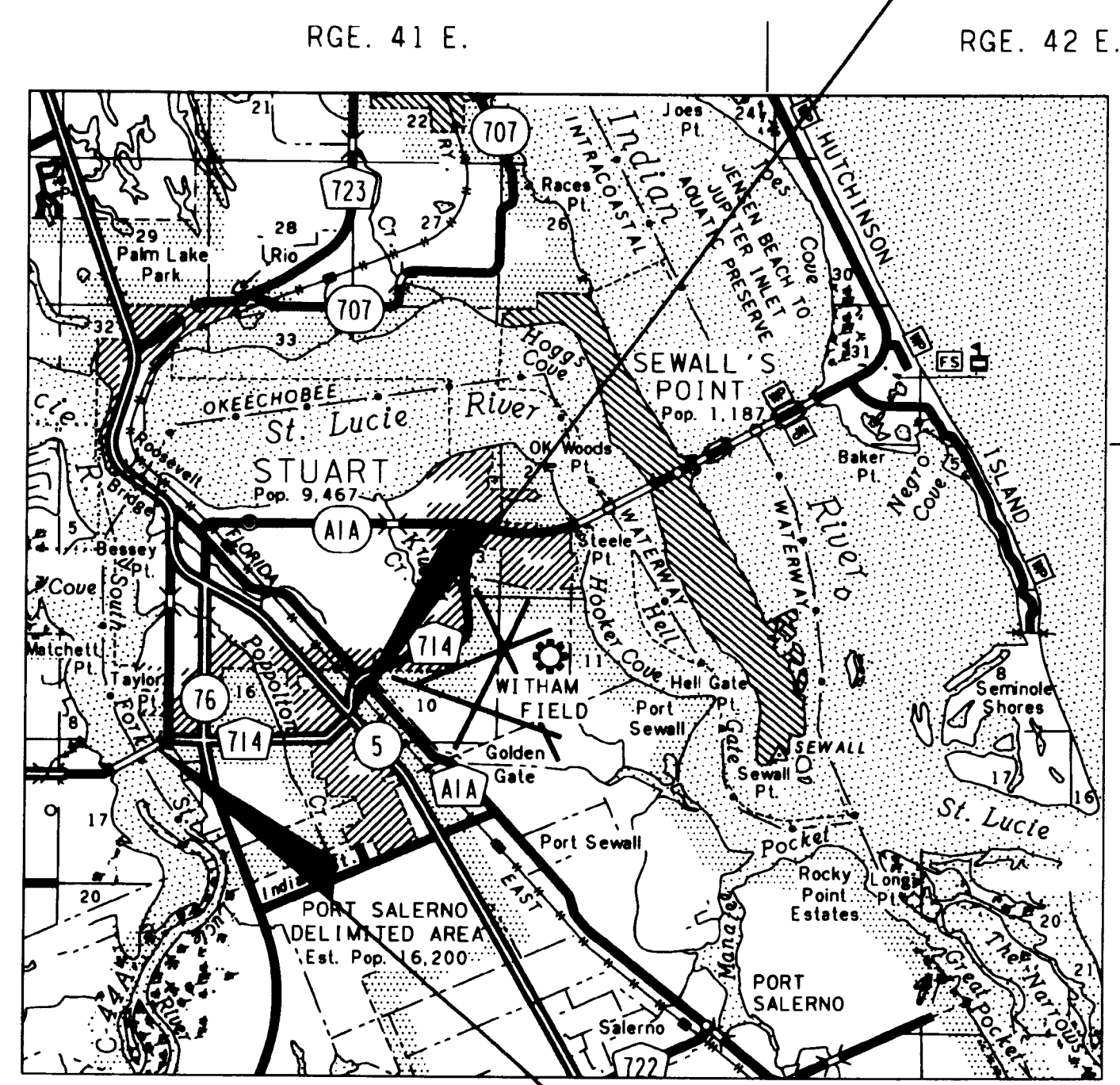

LOCATION MAP  
SCALE: 1" = 1 MILE

BEGIN MAINT. PROJECT No. 89092-MAINT.(1)  
@ STA. 77+36.06

INDEX

SHEET NO.	SHEET DESCRIPTION
1	COVER SHEET
2-8	DETAIL SHEETS

MAINTENANCE MAP CERTIFICATION

THIS IS TO CERTIFY that the within and attached sheets numbered 1 to 8, inclusive, constitute a true copy of the official Maintenance Map showing location and survey by the State of Florida Department of Transportation for a portion of State Road 714, designated as Section 89092-MAINT.(1) in MARTIN County, Florida.

THE PROPERTY labeled MAINT. R/W on said sheets has been vested in the State of Florida Department of Transportation pursuant to the provision of Section 95.361 Florida Statutes.

IN WITNESS WHEREOF, we have hereunto set our hands and affixed the seal of the State of Florida Department of Transportation, in Ft. Lauderdale, Florida this 25 day of November, A.D. 2003.

/s/ GERRY O'REILLY  
Gerry O'Reilly  
District Director of Planning and Production  
Department of Transportation  
State of Florida

/s/ MARIA GUTIERREZ  
(Attestor)

SURVEYOR'S CERTIFICATION

This survey was performed for the specific purpose of establishing a survey line and locating the limits of maintained right of way as identified by the Maintenance Engineer for the transportation facility shown and depicted hereon.

I hereby certify that to the best of my knowledge and belief this is a true, accurate and complete depiction of a field survey performed under my direction and completed on January 14, 2003.

I further certify that said drawing is in compliance with the Minimum Technical Standards as set forth by the Florida Board of Professional Surveyors and Mappers, in Chapter 61G17-6 Florida Administrative Code pursuant to Section 472.027, Florida Statutes.

/s/ JAMES F. NOTH  
JAMES F. NOTH  
Florida Professional Surveyor and Mapper No. 3871  
Address: 1402 ROYAL PALM BEACH BLVD., BUILDING 500  
ROYAL PALM BEACH, FLORIDA 33411

Date: 11-18-03

NOT VALID WITHOUT SIGNATURE AND ORIGINAL RAISED SEAL

MAINTENANCE ENGINEER CERTIFICATION

This is to certify that the right of way limits as shown on this map were identified by myself as having been maintained continuously for four (4) years without interruption.

By: /s/ ASEM AL TURK  
ASEM AL TURK  
Maintenance Engineer

CLERK OF COURT CERTIFICATION

Filed for record in the office of the Clerk of the Circuit Court for the County of MARTIN, State of Florida, in Plat Book 15, Page 79, on the 22nd day Dec., A.D. 2003.

/s/ MARSHA EWINS  
Clerk of the Circuit Court  
Martin County, Florida  
/s/ BY CHARLOTTE BURKEY  
FILE: 1717162

COVER SHEET

S.R. 714 (S.E. MONTEREY ROAD) FROM PALM CITY ROAD TO S.R. 5 (U.S. 1)

MAINTENANCE MAP	FLORIDA DEPARTMENT OF TRANSPORTATION RIGHT OF WAY MAPPING	APPROVED BY	DATE	BY	DATE	FED. PROJ. NO.	N/A	SECTION	89092-MAINT.(1)	MAPS PREPARED BY	F.D.O.T. DISTRICT 4	FIELD BOOK NO.'S	SEE ABOVE, TOP LEFT
		DISTRICT RIGHT OF WAY SURVEYOR				PRELIM	MORAVA	03-17-03	STATE ROAD No. 714	MARTIN COUNTY	W.P.I. No. N/A	SCALE: 1" = 1 MILE	ITEM/SEGMENT NO. 2288621
		REVISION	BY	DATE	REVISION	BY	DATE	CHECKED	BROWN	06-25-03			